



Interlock System

Component Location Index

CAUTION:

- All SRS wiring harnesses are covered with yellow outer insulation.
- Before disconnecting any part of the SRS wire harness, install the short connectors (see page [23-409](#)).
- Replace the entire affected SRS harness assembly if it has an open circuit or damaged wiring.

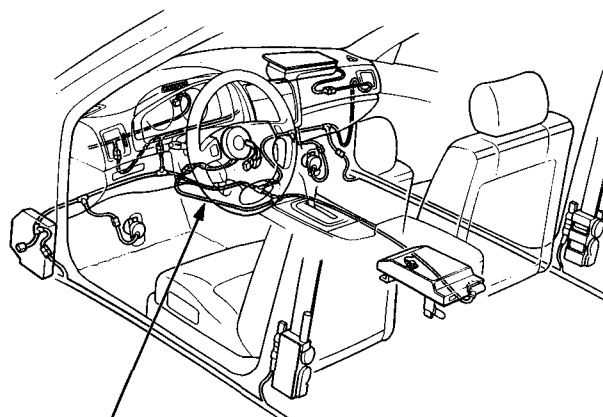

SRS MAIN HARNESS
(Covered with yellow outer insulation)

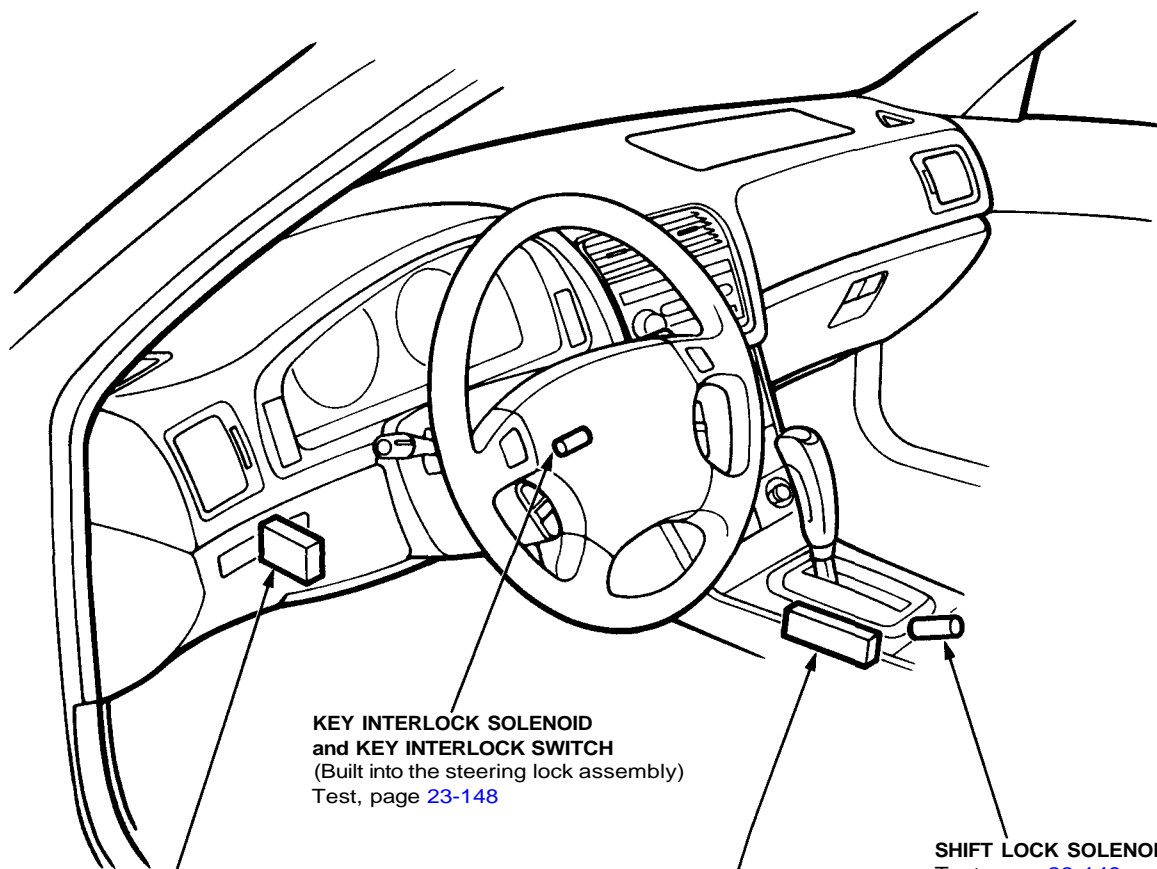

INTERLOCK CONTROL UNIT
Input test, page [23-147](#)

**KEY INTERLOCK SOLENOID
and KEY INTERLOCK SWITCH**
(Built into the steering lock assembly)
Test, page [23-148](#)

A/T GEAR POSITION SWITCH
Test, page [23-154](#)
Replacement, page [23-155](#)

SHIFT LOCK SOLENOID
Test, page [23-149](#)
Replacement, page [23-149](#)